

RESMED

MIRAGE[®] MASK COMPONENTS

MIRAGE[®] MASK

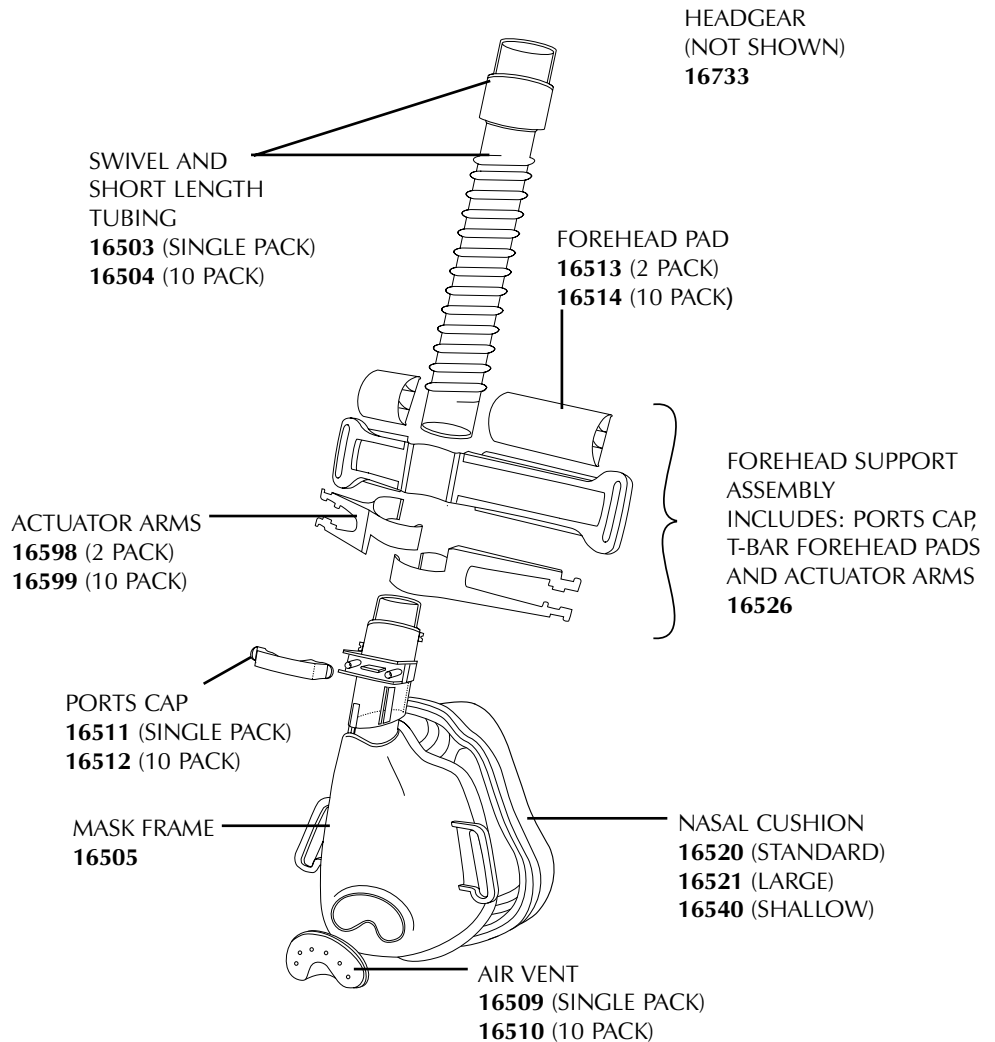

MIRAGE MASK ACCESSORIES

PART NUMBER	DESCRIPTION
16524	Hytrex Tubing (10 pack)
16527	Stability Strap
16528	Extension Pipe
16588	Extension Pipe (10 pack)

FULLY ASSEMBLED MIRAGE MASK

PART NUMBER	DESCRIPTION
16518	Mirage Mask System - Standard
16519	Mirage Mask System - Large
16538	Mirage Mask System - Shallow

