

Mirage Activa™ LT

NASAL MASK

Components Card

English

Complete system	ANZ	Asia Pacific	Japan
M*	60163	60148	60160
L*	60164	60149	60161
LW*	60165	60150	60162

Elbow assembly

(elbow, swivel)

16399

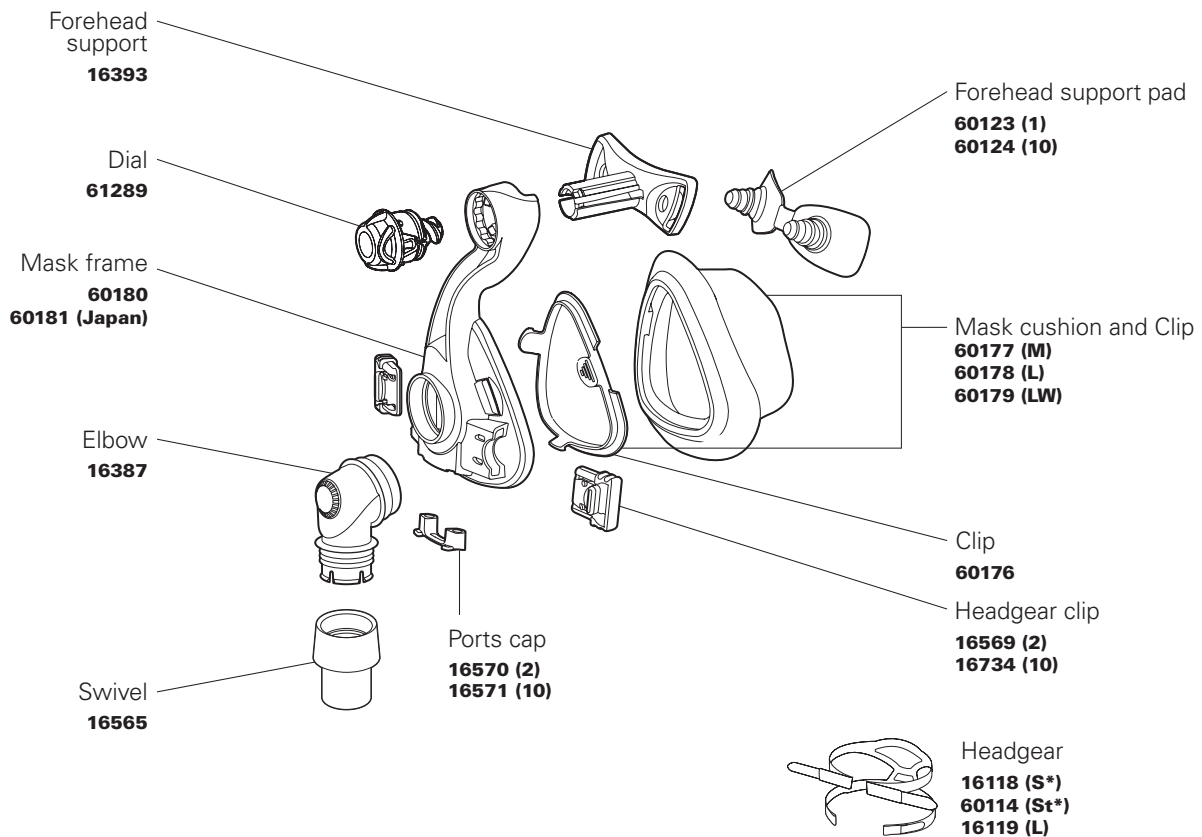

M* Medium

L* Large

LW* Large Wide

S* Small

St* Standard

ResMed Ltd (Manufacturer) 1 Elizabeth Macarthur Drive, Bella Vista, NSW, Australia +61 (2) 8884 1000 or 1 800 658 189 (toll free), ResMed Corp (US Designated Agent) 14040 Danielson Street, Poway, CA 92064-6857 USA +1 858 746 2400 or 1 800 424 0737 (toll free), ResMed (UK) Ltd (EU Authorised Representative) 96 Milton Park, Abingdon, Oxfordshire OX14 4RY UK. Offices in Austria, Belgium, Brazil, China, Finland, France, Germany, Greece, Hong Kong, India, Ireland, Italy, Japan, Malaysia, Mexico, Netherlands, New Zealand, Norway, Portugal, Singapore, South Africa, Spain, Sweden, Switzerland, United Kingdom (see website for details). Protected by patents: AU 2001267133, AU 710733, AU 741003, AU 766623, AU 775051, AU 777033, AU 785376, CA 2261790, DE 20122844.0, EP 0956069, EP 1187647, EP 1187649, EP 1187650, EP 1314445, EP 1334742, EP 1479406, EP 1582230, EP 1640034, HK 1057714, HK 1071083, JP 3686609, JP 3802872, JP 4031422, NZ 513052, NZ 526165, NZ 526166, NZ 526167, NZ 526168, NZ 542849, NZ 543939, US 6112746, US 6119693, US 6357441, US 6374826, US 6439230, US 6463931, US 6532961, US 6557556, US 6581594, US 6581602, US 6634358, US 6691708, US 6772760, US 6823865, US 6823869, US 6860269, US 6871649, US 6986352, US 6997188, US 7107989, US 7159587, US 7178527, US 7216647, US 7234466, US 7243651, US 7318439. Other patents pending. Protected by design registrations: AU 156663, FR 031430, JP 1192859, US D487510, US D493521, AU 156665, DE 40301991.5, FR 031425, JP 1197930, US D486227, US D493522, US D545960, US D567935. Others pending. Mirage and Activa are trademarks of ResMed Ltd and are registered in U.S. Patent and Trademark Office. Specifications may change without notice. © 2008 ResMed Ltd. 1012867/1 08 08